

# TX7331

## Intelligent Graphic Repeater Panel

### Feature and Benefits

EN54-2 Compliance

Fire display passive repeater panel

Built-in MCU processor and digital addressing

Fast response of audible and visible signal from the panel

Programmable Zone Display a particular zone or device and indicate the groups or device

Supervise information and indicate the specific device type for 68/69/70 of activate information (maximum support 100 groups supervise or activate information at the same time)

LED status indicator

Onsite Adjustable Parameter

Loop sited wiring with external 24V supply

Compact size and aesthetically pleasing design

### Overview

TX7331 Intelligent Graphic Repeater Panel is designed with built-in MCU processor and it can fast relay response with simultaneous audible and visual signal output. This repeater panel can also program to limit the zone display from All Zones into a particular zone or device. Also it can supervise and indicate the groups as well as device. The unit is connected through the communication loop of TX7004 Intelligent control panel along with the devices and can install up to 254 units per loop. The repeater panel can be used whenever there is a need to relay information to multipoint informing key personnel.

The unit is manufactured base on the requirem ent of EN 54 part 2, European Standard. The unit is compact size and aesthetically pleasing with unobtrusive design that will complement modern building designs. The unit is compatible to the TX7004 Analogue Intelligent Fire Alarm Control Panel, produced by single manufacture T&A, to avoid addressable communication compatibility problem.



**TANDA Development Pte.Ltd.**

217 Kallang Bahru #04-02

Singapore 339347

Tel: (65) 6291 3176

Email: [info@tandatech.com](mailto:info@tandatech.com)

Web: [www.tnafirealarm.com](http://www.tnafirealarm.com)

**TANDA Development Pte.Ltd. | DATASHEET**

Copyright © The information contained within these data sheets remains the property of TANDA Development Pte.Ltd. and is not to be altered or reproduced without written permission. TANDA reserves the right to change any specification without giving prior

## Technical Specification

Compliance	EN 54-2: 1997+A1: 2006
Input Voltage	Loop Power:24VDC [16V to 28V] External PSU:24 VDC [20V to 28V]
Current Consumption	Loop: Standby: 1mA, Alarm: 1.2mA External PSU: Standby 25mA, Alarm: 80mA
Memory Capacity	Up to 256 fire event history
Number per loop	Up to 254 units (ideal)
Material / Colour	Flat sheet Metal / black
Dimension / LWH	394mm x 274mm x63mm(Can according to user requirements,the dimension should be amended accordingly)
Operating Temperature	0° C to +40° C
Humidity	0 to 95% Relative Humidity, Non condensing

## Installation and Wiring

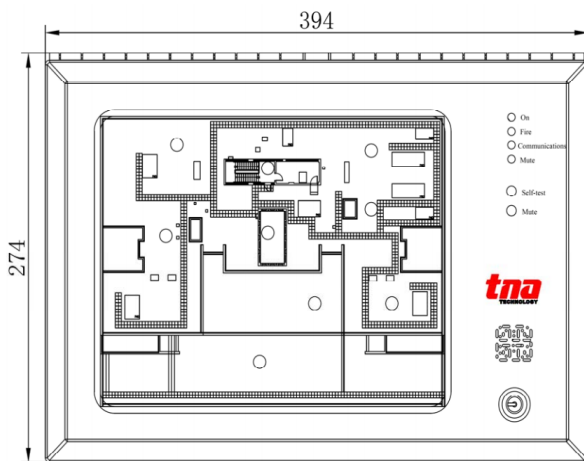

Figure 1

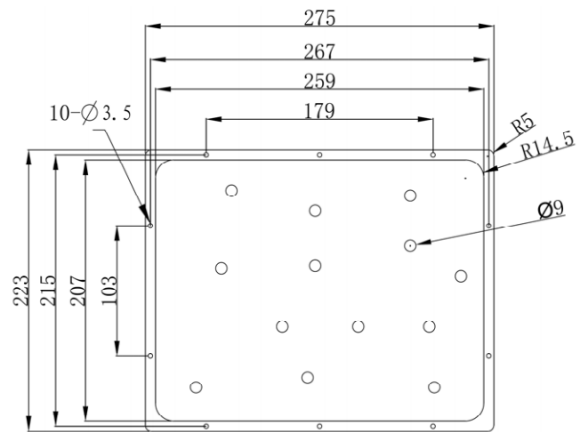

Figure 2

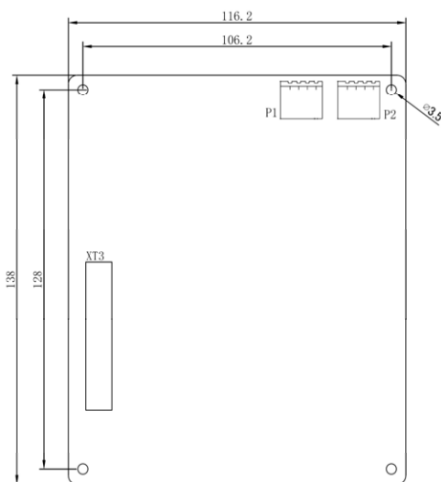
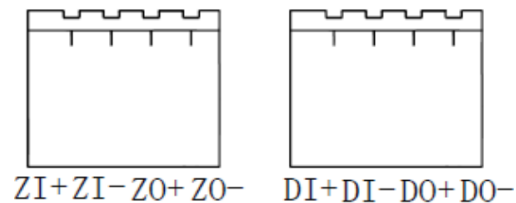

Figure 3



### TerminalDescription

ZI+, ZI-, ZO+, ZO-: The communication cable terminals connecting with the fire alarm control panel.  
DI+, DI-, DO+, DO-: 24DC power supply wiring terminal, non polarized.

